

KNOTWOOD™ CLADDING SYSTEM

PROFILE

KEC200 8" CLADDING/SOFFIT



8" Cladding / Soffit Panel KEC200 (Special Order Item)

SPECIFICATIONS

Imperial Size:	8" x 5/8" x 18'6"
Metric Size:	200mm x 16mm x 5650mm
Material Thickness:	1.4mm
Uses:	Cladding, Soffit
Weight per Piece:	18.79 LBS/ 8.52 KG
Weight / Sq. Foot:	1.01 LBS/ 0.45 KG
Coverage / piece:	12.33 Sq. Feet / 1.14 Sq. Meters
Case Coverage:	493.20 Sq. Feet / 45.81 Sq. Meters
Case Quantity:	40 pieces

FEATURES

Interlocking Assembly
 Top down or Bottom up installation
 Horizontal, Vertical, Diagonal
 0 to 1/4" Reveal between Panels
 Fastening 32" on center or less
 Quick install Cladding Clips
 30+ Woodgrain Colors
 70+ Solid and Custom Colors

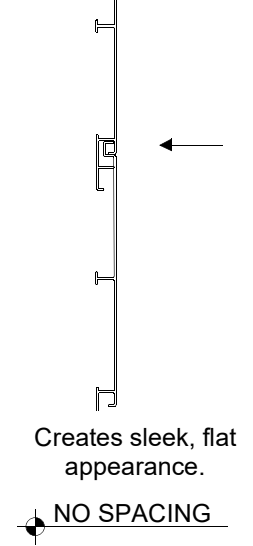
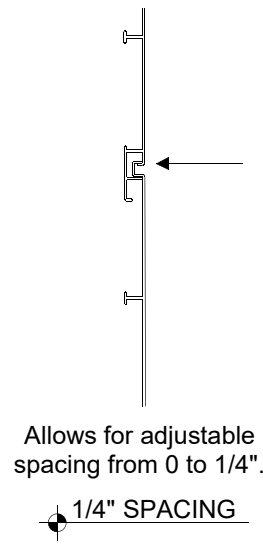
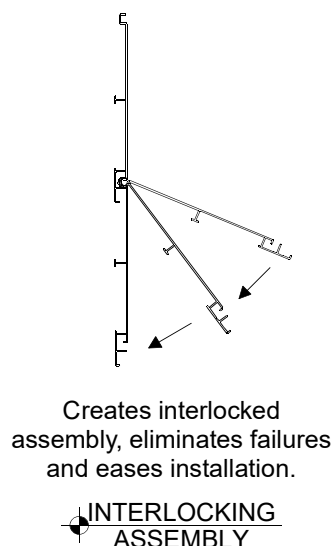
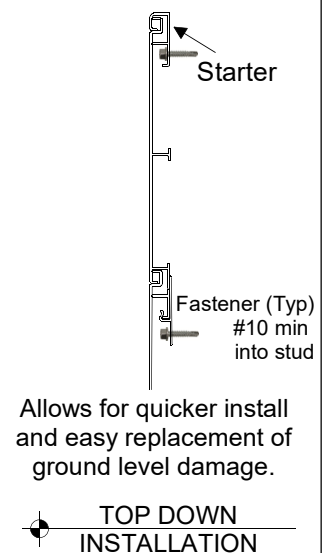
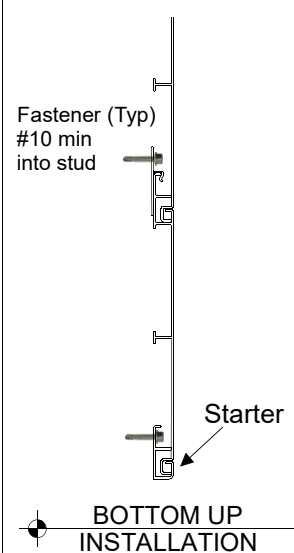
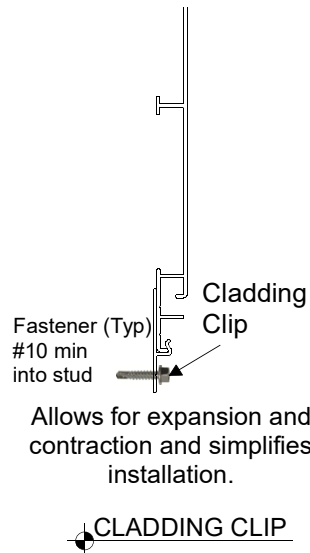
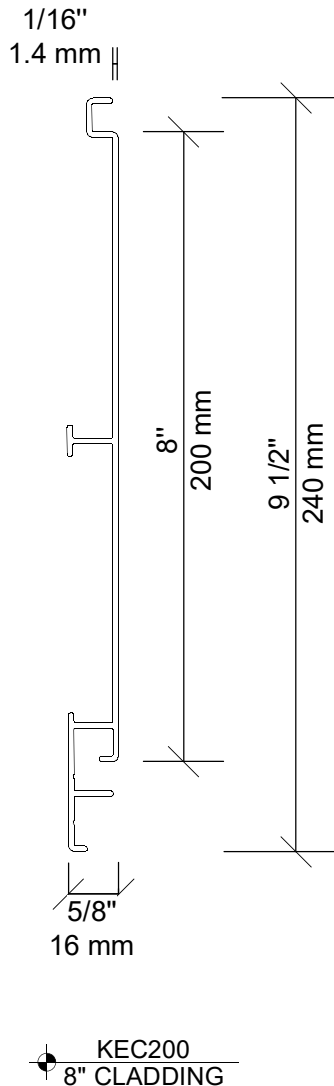

KNOTWOOD™ CLADDING SYSTEM

8" CLADDING (KEC200) BOTTOM UP ASSEMBLIES

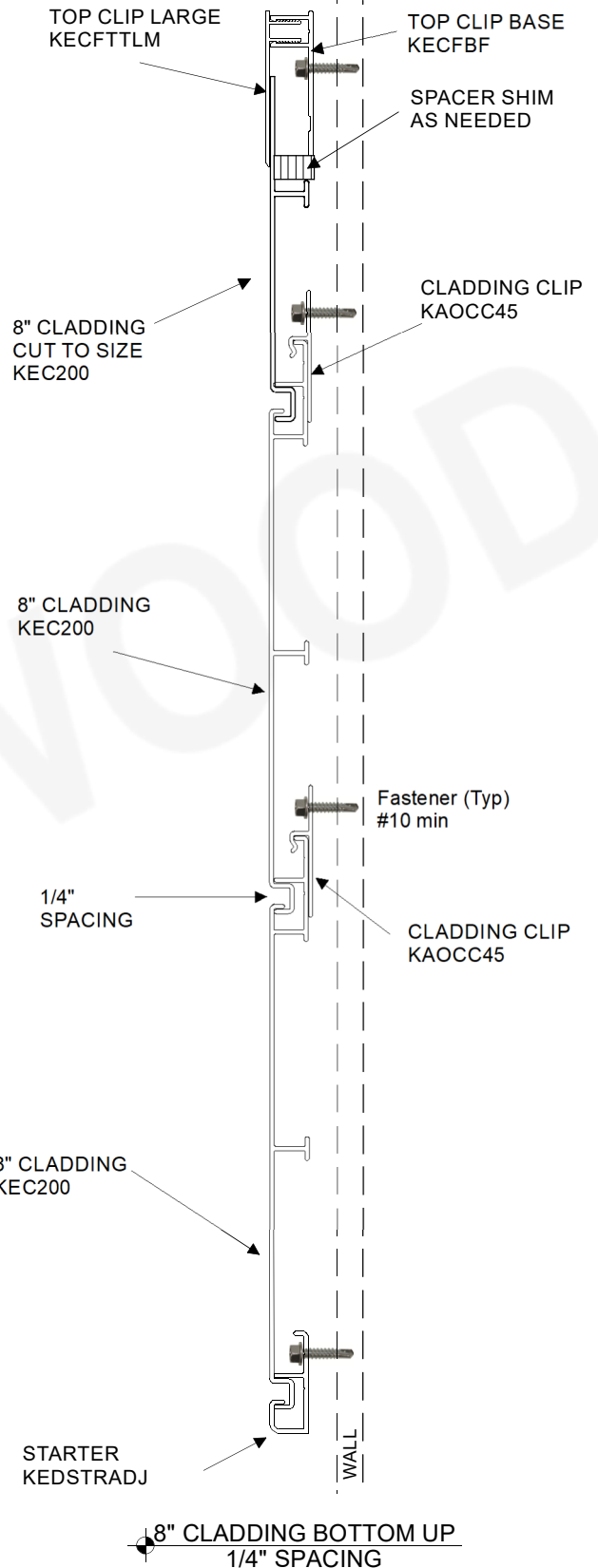
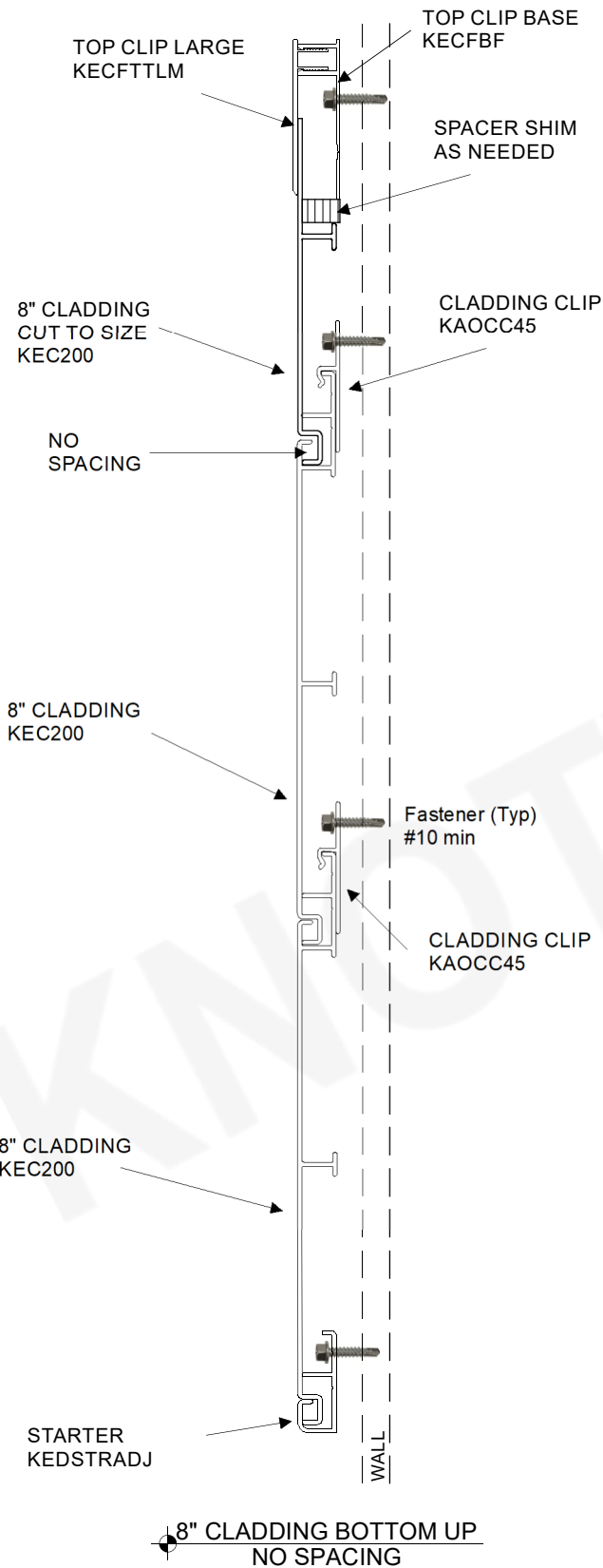

KNOTWOOD™ CLADDING SYSTEM

8" CLADDING (KEC200) TOP DOWN ASSEMBLIES

